

DRG No. CS/75844/02/OPTION 2 REVISION REF.

KEY:

- DENOTES EXTENT OF PROPOSED ONE WAY
- DENOTES EXTENT OF PROPOSED 20 MPH ZONE (2 No TERMINAL SIGNS TO BE PROVIDED ON THE ENTRY POINT OF THE ZONE)
-
 DENOTES SPEED CUSHION 3.0m x 1.7m x 75mm ON ONE WAY SECTION SINGLE HUMP TRIANGLE MARKING FOR ONCOMING TRAFFIC (SILKSTREAM ROAD)
-
 DENOTES SPEED CUSHION 3.0m x 1.7m x 75mm ON TWO WAY SECTION HUMP TRIANGLE MARKINGS APPLIED FOR BOTH DIRECTIONS (GASKARTH ROAD, PLAYFIELD ROAD)

DYL REFERS TO DOUBLE YELLOW LINES

NOTE:

AT SPEED CUSHION LOCATIONS LOCALISED RESURFACING MAYBE REQUIRED TO AVOID CUSHIONS BEING INSTALLED ON POOR ROAD SURFACE

ALL FEATURES ARE SHOWN AS INDICATIVE LOCATIONS AND WILL BE SUBJECT TO DETAILED DESIGN

This product includes mapping data licensed from Ordnance Survey with the permission of the Controller of Her Majesty's Stationery Office. © Crown copyright and database right 2013. All rights reserved. London Borough of Barnet. Licence No 100017674

HEALTH, SAFETY & ENVIRONMENTAL INFORMATION

NOTE: IT IS ASSUMED THAT THE WORKS WILL BE UNDERTAKEN BY A COMPETENT CONTRACTOR, WHO IS AWARE OF ALL GENERIC RISKS ASSOCIATED WITH THE WORKS. LISTED BELOW ARE 'SIGNIFICANT' RISKS RELATING TO THE WORKS.

If no significant risks have been identified, delete this text and enter 'NONE IDENTIFIED' here.

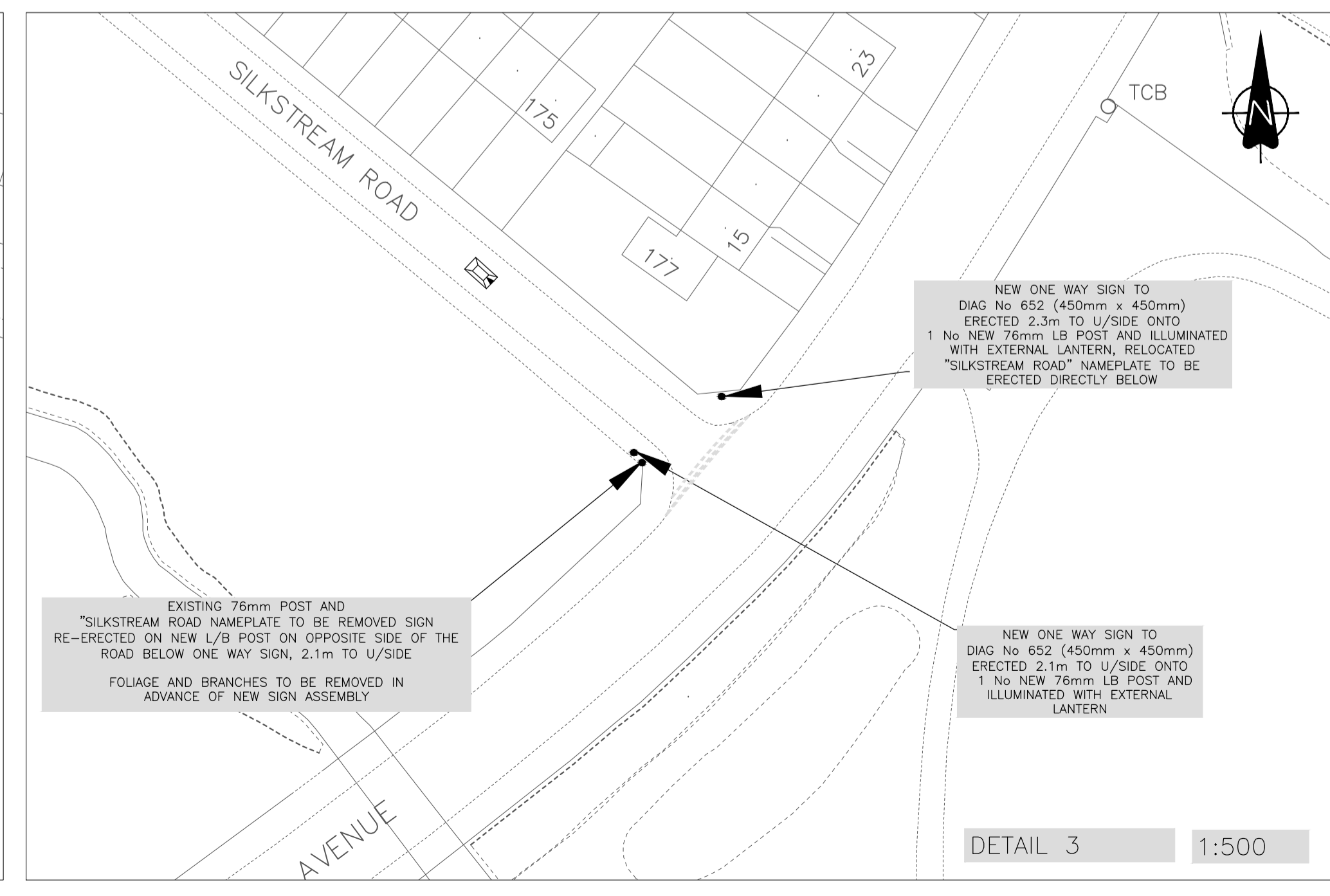
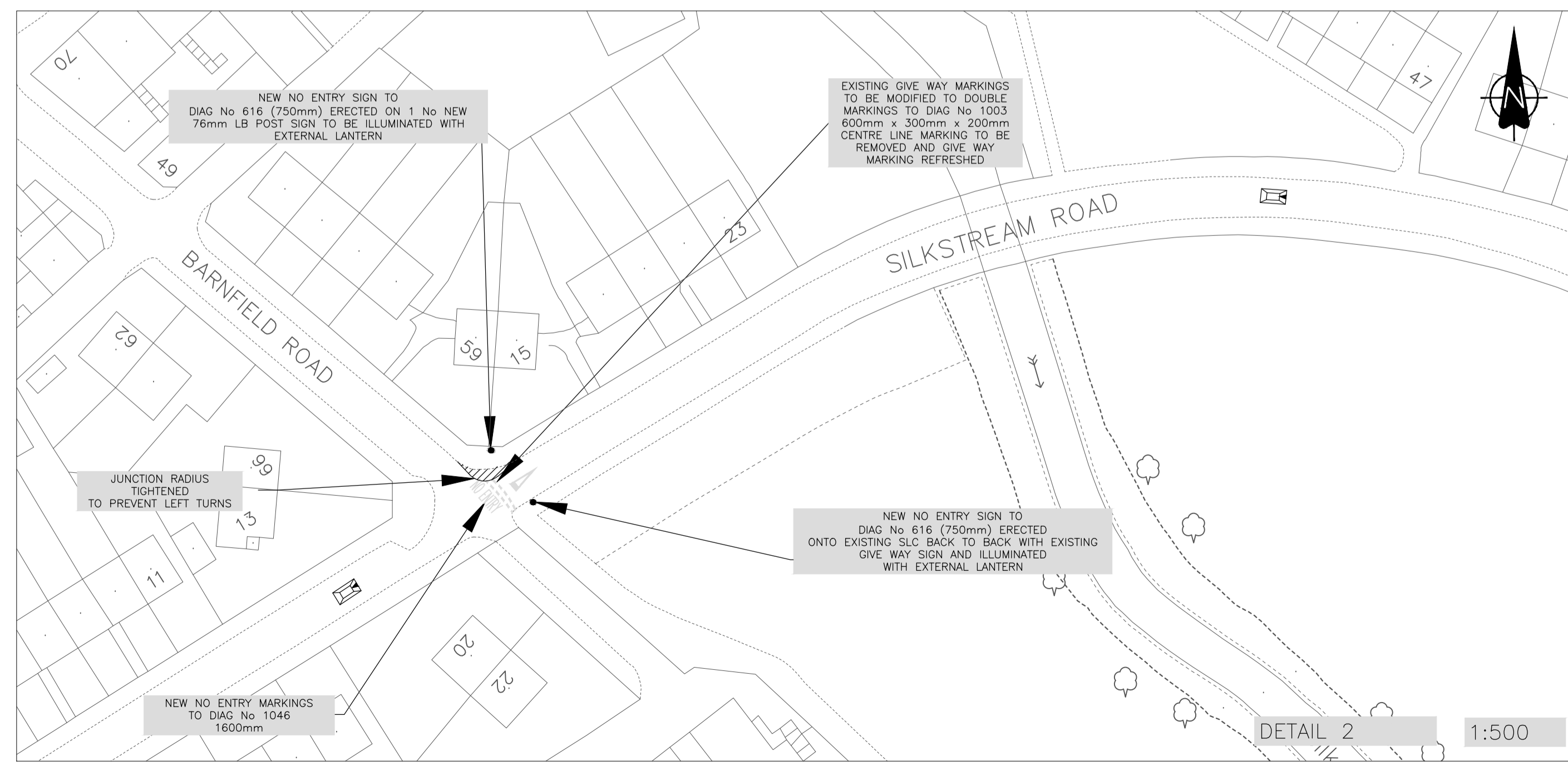
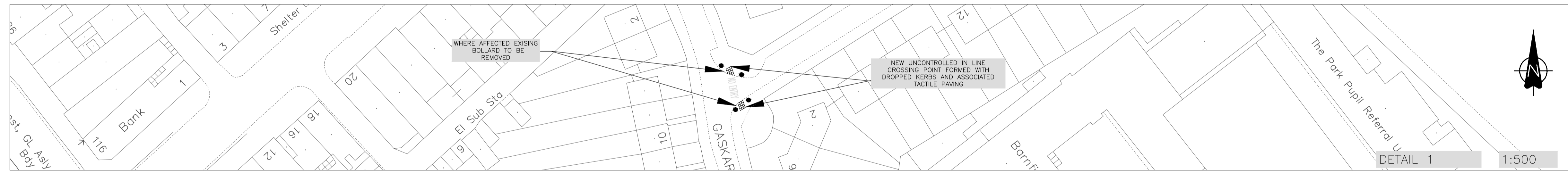

ISSUE	AMENDMENTS	DRAWN	CHECKED	DATE	
CLIENT					
PROJECT	TRAFFIC MANAGEMENT AND ACCIDENT REDUCTION (LIP 2014/15)				
TITLE	SILKSTREAM ROAD PRELIMINARY DESIGN OPTION 2				
PURPOSE	INFORMATION				
St Davids House, Pascal Close, St Mellons, Cardiff, CF3 0LW T: 02920 803500 w: www.capita.co.uk/infrastructure Capita Property and Infrastructure Ltd.					
DRAWN	HK	DATE	SEPT 2014	SCALE	AS SHOWN
CHECKED	KE	DATE	SEPT 2014	PROJECT No.	CS/75844
DRG. No.	CS/75844/02/OPTION 2			REVISION REF.	